

Galway County Council Connemara Greenway Clifden to Oughterard

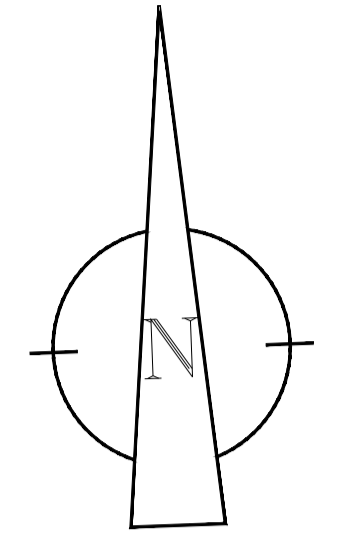

Site Location

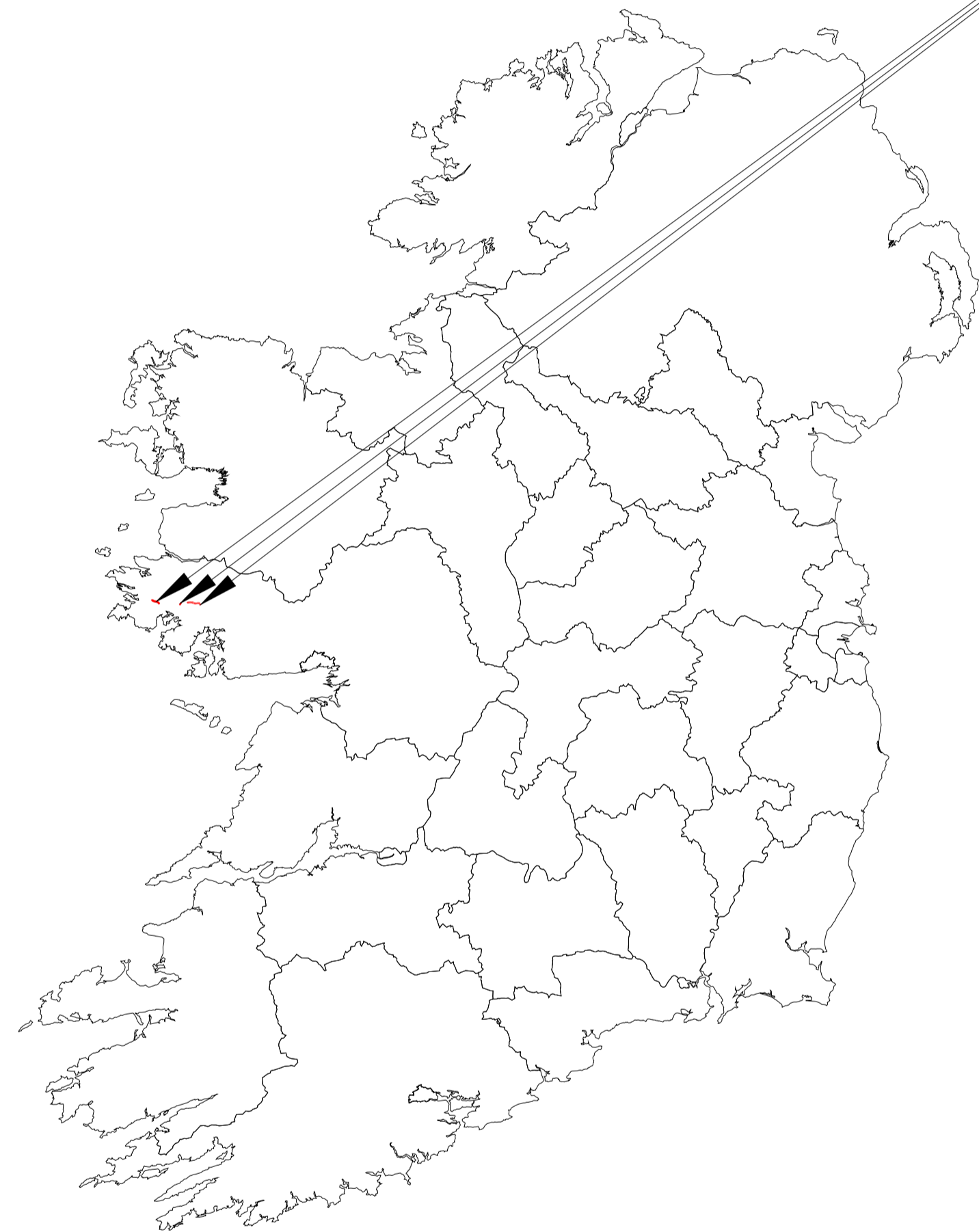

Location Map

SCALE 1:50,000 @ A1, 1:100,000 @ A3

National Roads Project Office
Galway County Council,
Corporate House,
Ballybrit Business Park,
Galway
Telephone: (091) 509 000
Fax: (091) 509 059



Comhairle Chontae na Gaillimhe
Galway County Council



Project Ireland 2040
Building Ireland's Future



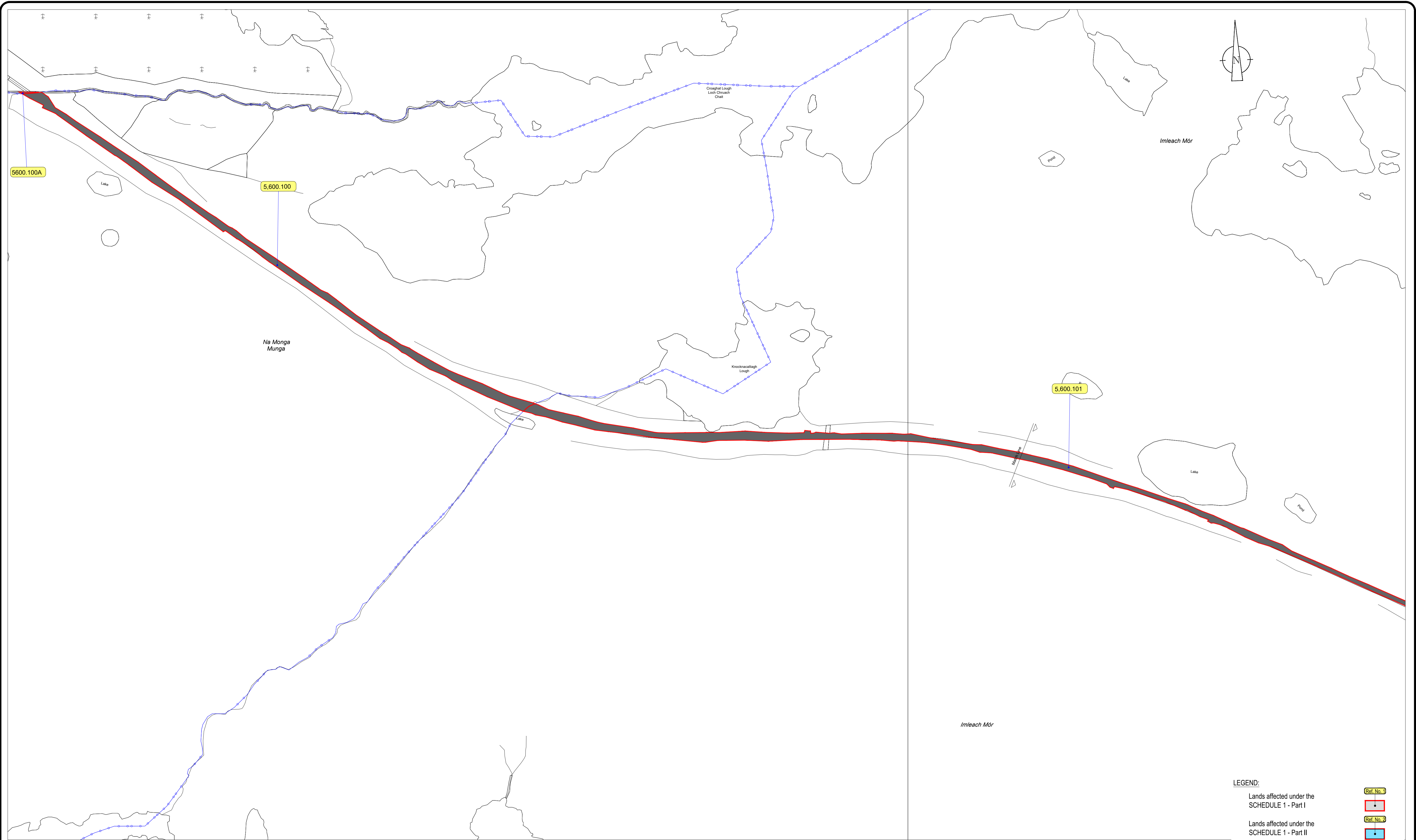

© Ordnance Survey Ireland. All rights reserved. Licence number 2010/15CCMA/Galway County Council.

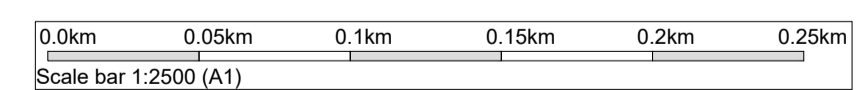

LEGEND:

- Lands affected under the SCHEDULE 1 - Part I ■
- Lands affected under the SCHEDULE 1 - Part II ■
- Public & Private rights of way proposed to be extinguished under the SCHEDULE 3 - Part I & II ■
- Townland Boundary —

Physical Infrastructure, Fire and Emergency Services & Climate Change,
National Roads Design Office,
Galway County Council,
Corporate House,
Ballybrit Business Park,
Galway.

REVISION:	MADE BY:	DATE:

The Official seal of Galway County Council was affixed hereto in the presence of

Nominated Employee for the purpose of authenticating the seal.

Dated this Day of July 2024

PROJECT	Connemara Greenway Project Phase 1		
COMPONENT:	Deposit Map		
TITLE:	Compulsory Purchase Order No.2 2024.		
DESIGNED BY:	K.L.	FILE NO.:	
DRAWN BY:	C.J.	SCALES:	1:2500 @ A1.
CHECKED BY:	A.J.	DATE:	June 2024
DRAWING NO.:			CG-CP0-2024-01-05



© Ordnance Survey Ireland. All rights reserved. Licence number 2010/15CCMA/Galway County Council.

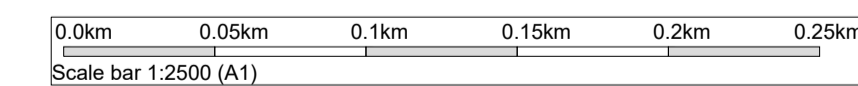

LEGEND:

- Lands affected under the SCHEDULE 1 - Part I
- Lands affected under the SCHEDULE 1 - Part II
- Public & Private rights of way proposed to be extinguished under the SCHEDULE 3 - Part I & II
- Townland Boundary



Comhairle Chontae na Gaillimhe
Galway County Council



GALWAY
NATIONAL ROADS
PROJECT OFFICE

Physical Infrastructure, Fire and Emergency Services & Climate Change,
National Roads Design Office,
Galway County Council,
Corporate House,
Ballybrit Business Park,
Galway.





REVISION:	MADE BY:	DATE:

The Official seal of Galway County Council was affixed hereto in the presence of

Nominated Employee for the purpose of authenticating the seal.

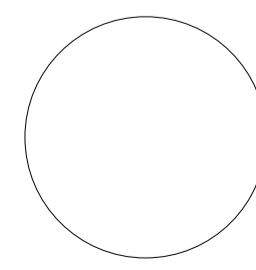
Dated this Day of July 2024



PROJECT: Connemara Greenway Project Phase 1	
COMPONENT: Deposit Map	
TITLE: Compulsory Purchase Order No.2 2024.	
DESIGNED BY: K.L.	FILE NO.:
DRAWN BY: C.J.	SCALE: 1:2500 @ A1.
CHECKED BY: A.J.	DATE: June 2024
DRAWING NO.: CG-CPO-2024-02-05	

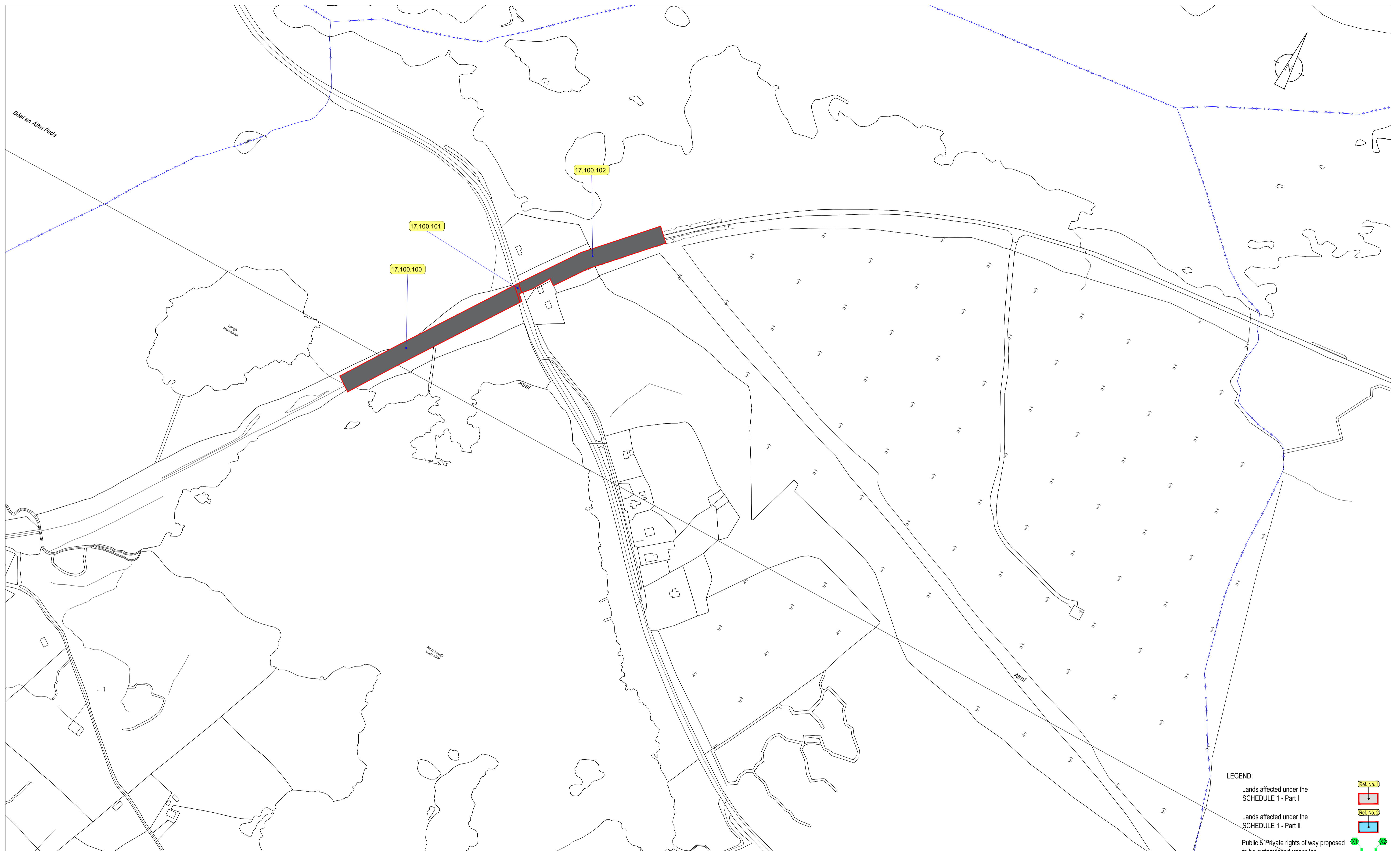

LEGEND:

- Lands affected under the SCHEDULE 1 - Part I
- Lands affected under the SCHEDULE 1 - Part II
- Public & Private rights of way proposed to be extinguished under the SCHEDULE 3 - Part I & II
- Townland Boundary

© Ordnance Survey Ireland. All rights reserved. Licence number 2010/15CCMA/Galway County Council.

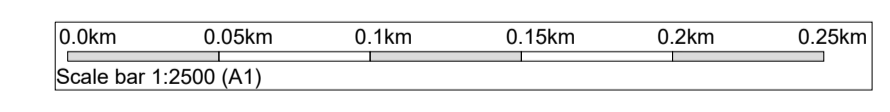

Comhairle Chontae na Gaillimhe
Galway County Council

GALWAY
NATIONAL ROADS
PROJECT OFFICE

Physical Infrastructure, Fire and Emergency Services & Climate Change,
National Roads Design Office,
Galway County Council,
Corporate House,
Ballybrit Business Park,
Galway.

Project Ireland 2040
Building Ireland's Future

REVISION:	MADE BY:	DATE:

The Official seal of Galway County Council was affixed hereto in the presence of

Nominated Employee for the purpose of authenticating the seal.

Dated this Day of July 2024

PROJECT: Connemara Greenway Project Phase 1

COMPONENT: Deposit Map

TITLE: Compulsory Purchase Order No.2 2024.

DESIGNED BY: K.L.	FILE NO.:
DRAWN BY: C.J.	SCALES: 1:2500 @ A1.
CHECKED BY: A.J.	DATE: June 2024

DRAWING NO.: CG-CP0-2024-03-05

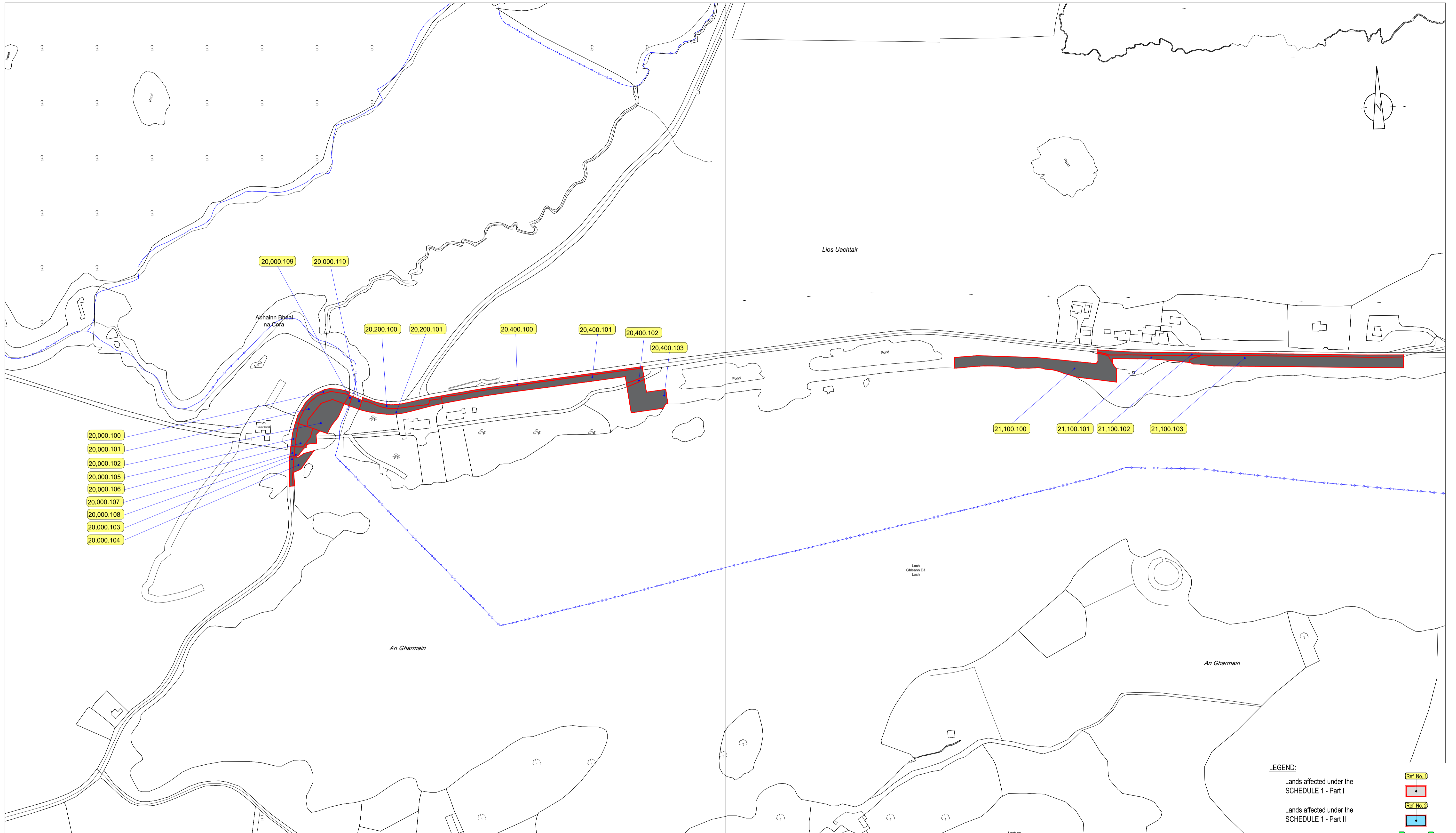

© Ordnance Survey Ireland. All rights reserved. Licence number 2010/15CCMA/Galway County Council.

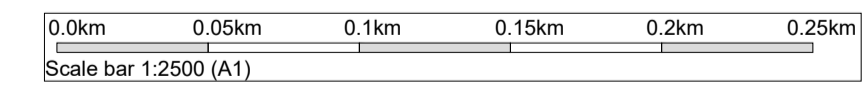

LEGEND:

- Lands affected under the SCHEDULE 1 - Part I
- Lands affected under the SCHEDULE 1 - Part II
- Public & Private rights of way proposed to be extinguished under the SCHEDULE 3 - Part I & II
- Townland Boundary

Physical Infrastructure, Fire and Emergency Services & Climate Change,
 National Roads Design Office,
 Galway County Council,
 Corporate House,
 Ballybrit Business Park,
 Galway.

REVISION:	MADE BY:	DATE:

The Official seal of Galway County Council was affixed hereto in the presence of

Nominated Employee for the purpose of authenticating the seal.

Dated this _____ Day of July 2024

PROJECT Connemara Greenway Project Phase 1

COMPONENT Deposit Map

TITLE Compulsory Purchase Order No.2 2024.

DESIGNED BY: K.L.	FILE NO.:
DRAWN BY: C.J.	SCALES: 1:2500 @ A1.
CHECKED BY: A.J.	DATE: June 2024

DRAWING NO.: CG-CPO-2024-04-05

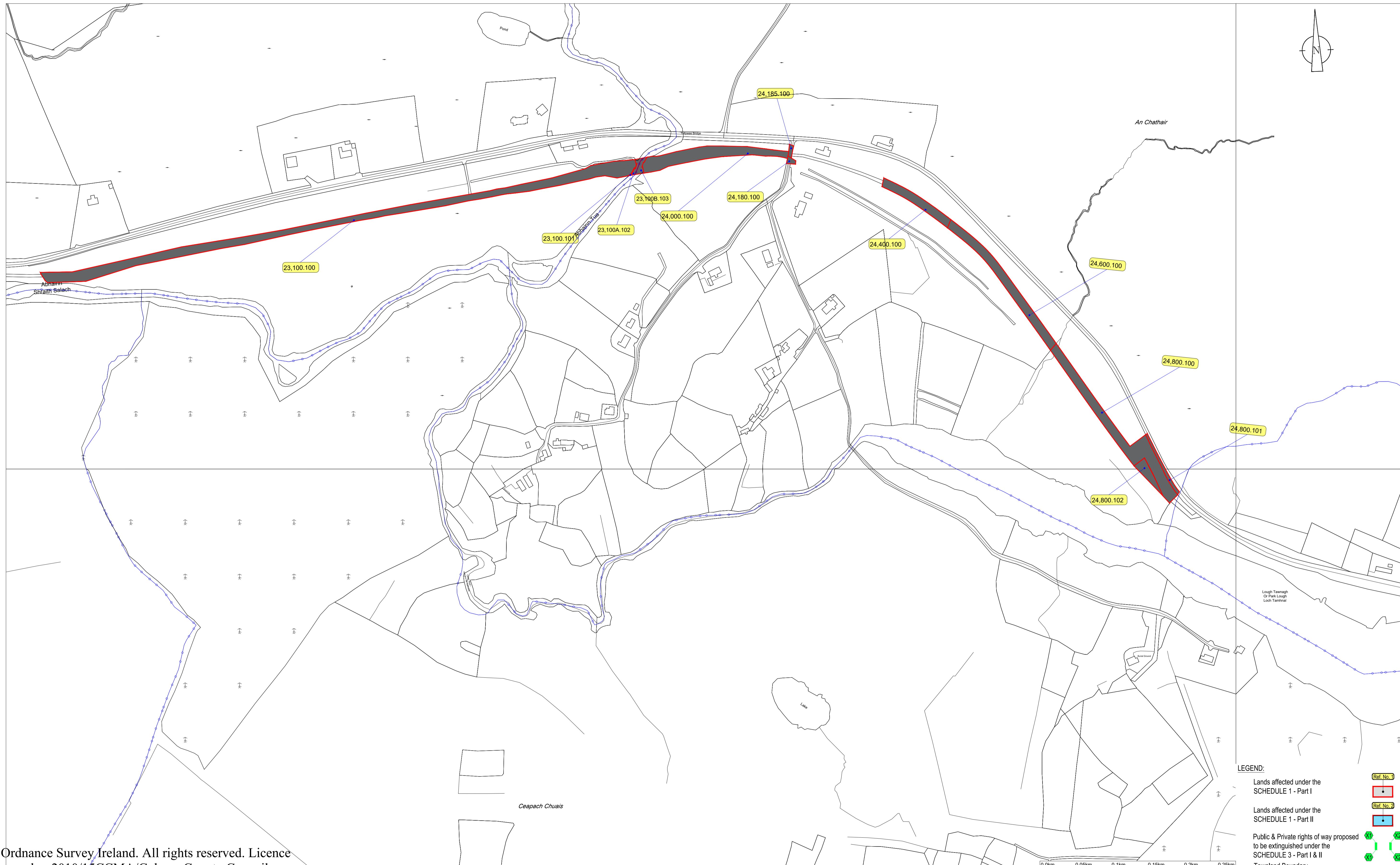

© Ordnance Survey Ireland. All rights reserved. Licence number 2010/15CCMA/Galway County Council.

LEGEND:

- Lands affected under the SCHEDULE 1 - Part I
- Lands affected under the SCHEDULE 1 - Part II
- Public & Private rights of way proposed to be extinguished under the SCHEDULE 3 - Part I & II
- Townland Boundary

Physical Infrastructure, Fire and Emergency Services & Climate Change,
National Roads Design Office,
Galway County Council,
Corporate House,
Ballybrit Business Park,
Galway.

REVISION:	MADE BY:	DATE:

The Official seal of Galway County Council was affixed hereto in the presence of

Nominated Employee for the purpose of authenticating the seal.

Dated this _____ Day of July 2024

PROJECT Connemara Greenway Project Phase 1

COMPONENT: Deposit Map

TITLE: Compulsory Purchase Order No.2 2024.

DESIGNED BY: K.L.	FILE NO.:
DRAWN BY: C.J.	SCALE: 1:2500 @ A1.
CHECKED BY: A.J.	DATE: June 2024

DRAWING NO.: CG-CPO-2024-05-05